



SAMPLE GAZEBO



SAMPLE BENCH



SAMPLE A.D.A. PATH

NOTES:

- PROPOSED ROAD WIDTH TO BE APPROXIMATELY 28 FEET WIDE
- PROPOSED 23 PARKING SPACES, 2 HANDICAP
- PROPOSED HEDGE ROW NOT TO EXCEED 4 FEET HIGH
- PROPOSED 6 FEET WIDE STONE DUST WALKING PATH TO BE A.D.A. COMPLIANT
- PROPOSED 12'X16' DOCK
- PROPOSED 16 FOOT GAZEBO
- PROPOSED BLACK IRON BENCHES

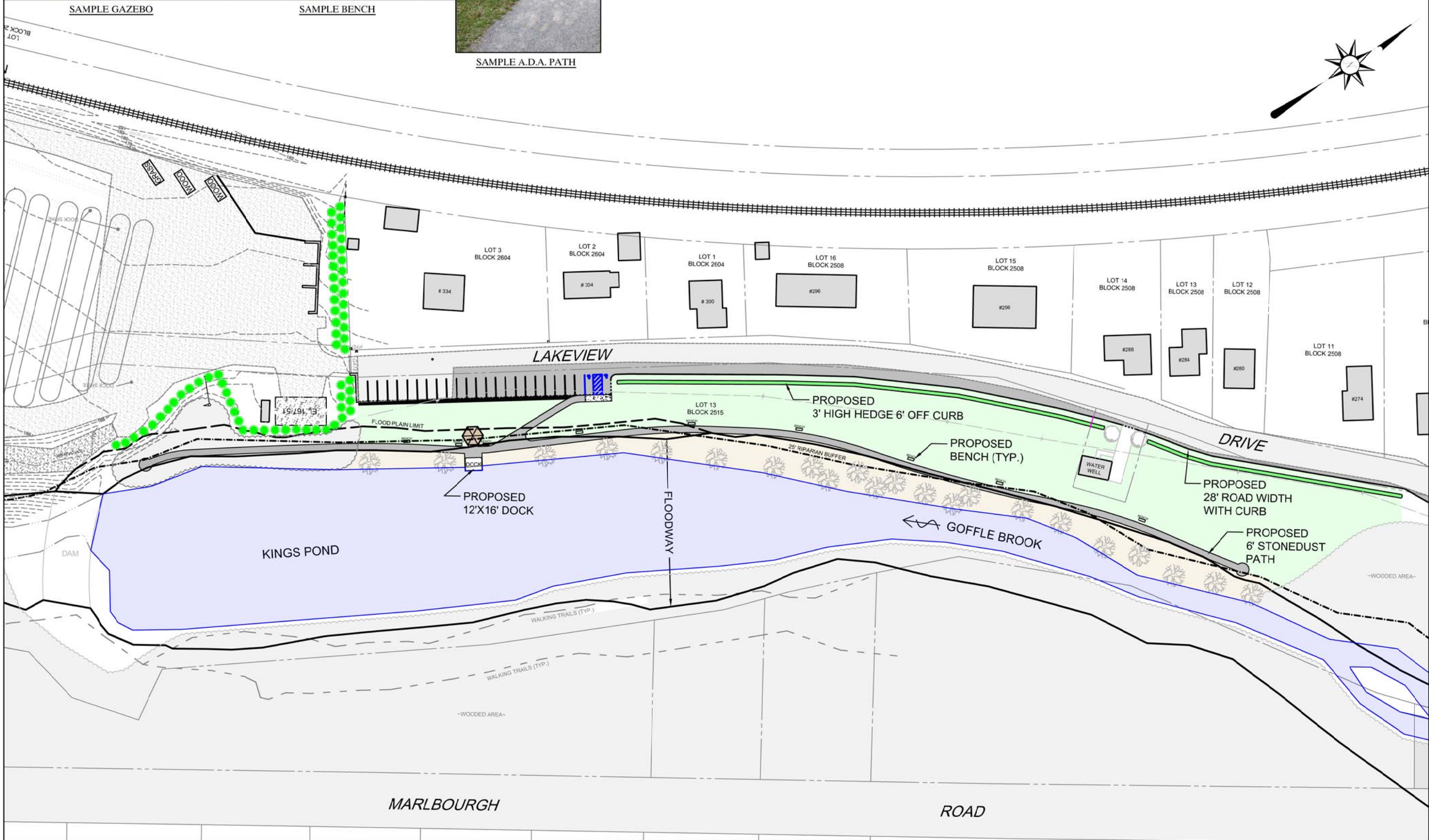
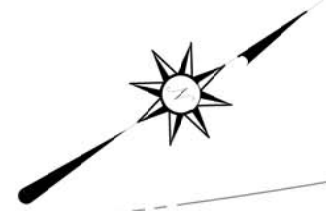

Christopher J. Ruitshausen  
Professional Engineer  
New Jersey License No. 16372

VILLAGE OF RIDGEWOOD  
Department of Public Works  
Division of Engineering  
131 North Maple Avenue  
Ridgewood, New Jersey 07450-3287  
201-670-5500 x 238

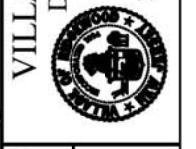

Issue Date:	1/9/18
Scale:	1" = 40'
Revision	
Date	

KING'S POND PARK  
CONCEPTUAL  
PROPOSED IMPROVEMENTS

File No.: 18035  
Sheet No.: 1 OF 1